

REVISIONS

1	
2	
3	
4	
5	DATE



DRAWING TITLE
Color Coded Structural Condition Assessment View from NW

DRAWING INFORMATION

Issue Date _____
 DATE OF ISSUE _____
 Schematic Design _____
 DESCRIPTION _____
 1/8" = 1'-0" Author _____
 SCALE DRAWN BY _____
 3246 3246 12NorthWestford.rvt
 PROJECT # FILE NAME

DRAWING NUMBER

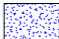
A204

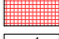
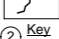

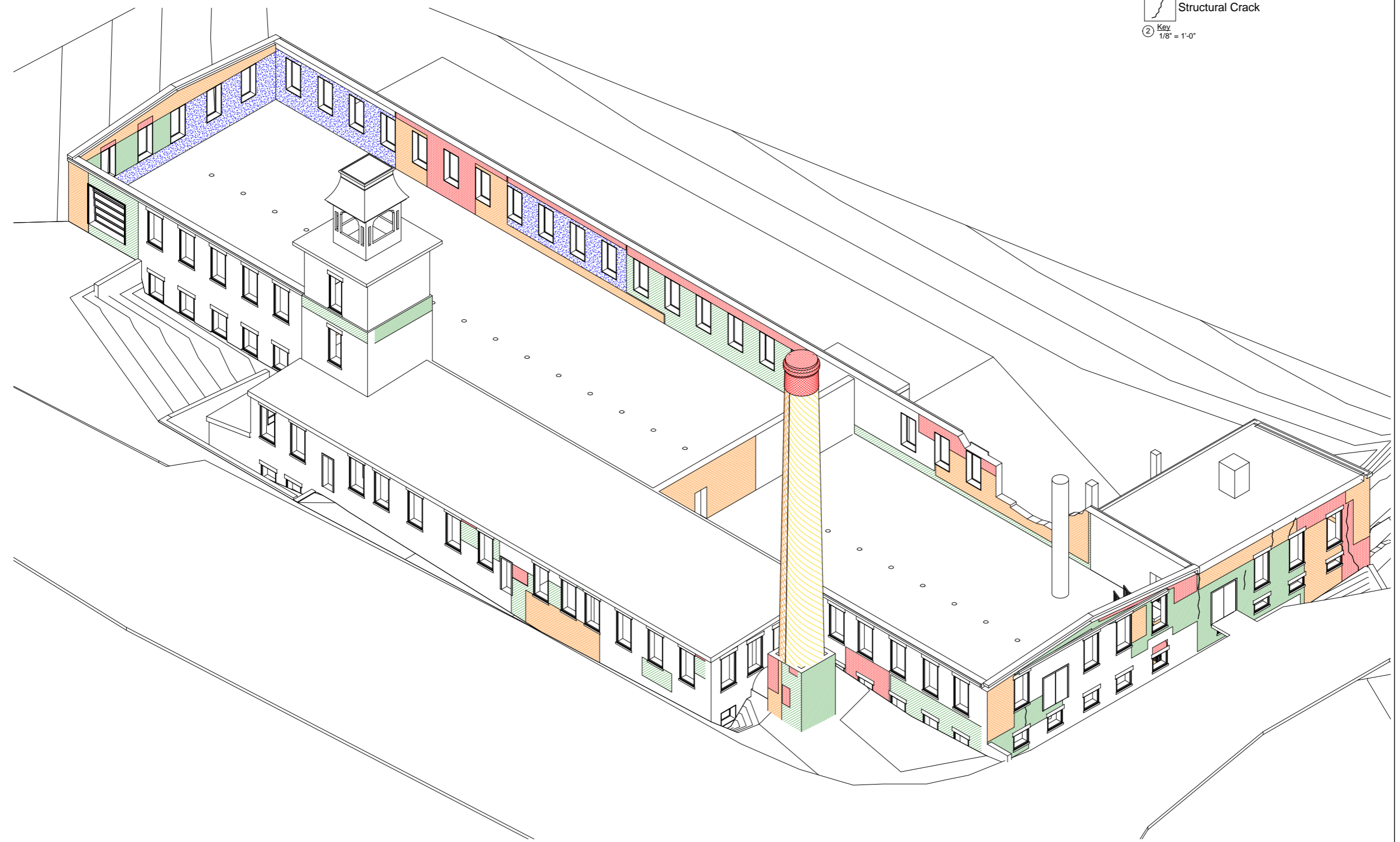

-  Surface covered with bonded plaster.
 -  Intact but with scattered to moderately eroded mortar joints.
 -  Deeply eroded mortar joints and scattered loose bricks or stones.
 -  Badly deteriorated, friable mortar, stones loose, shifting.
 -  Structural Crack
- ② Key
 1/8" = 1'-0"

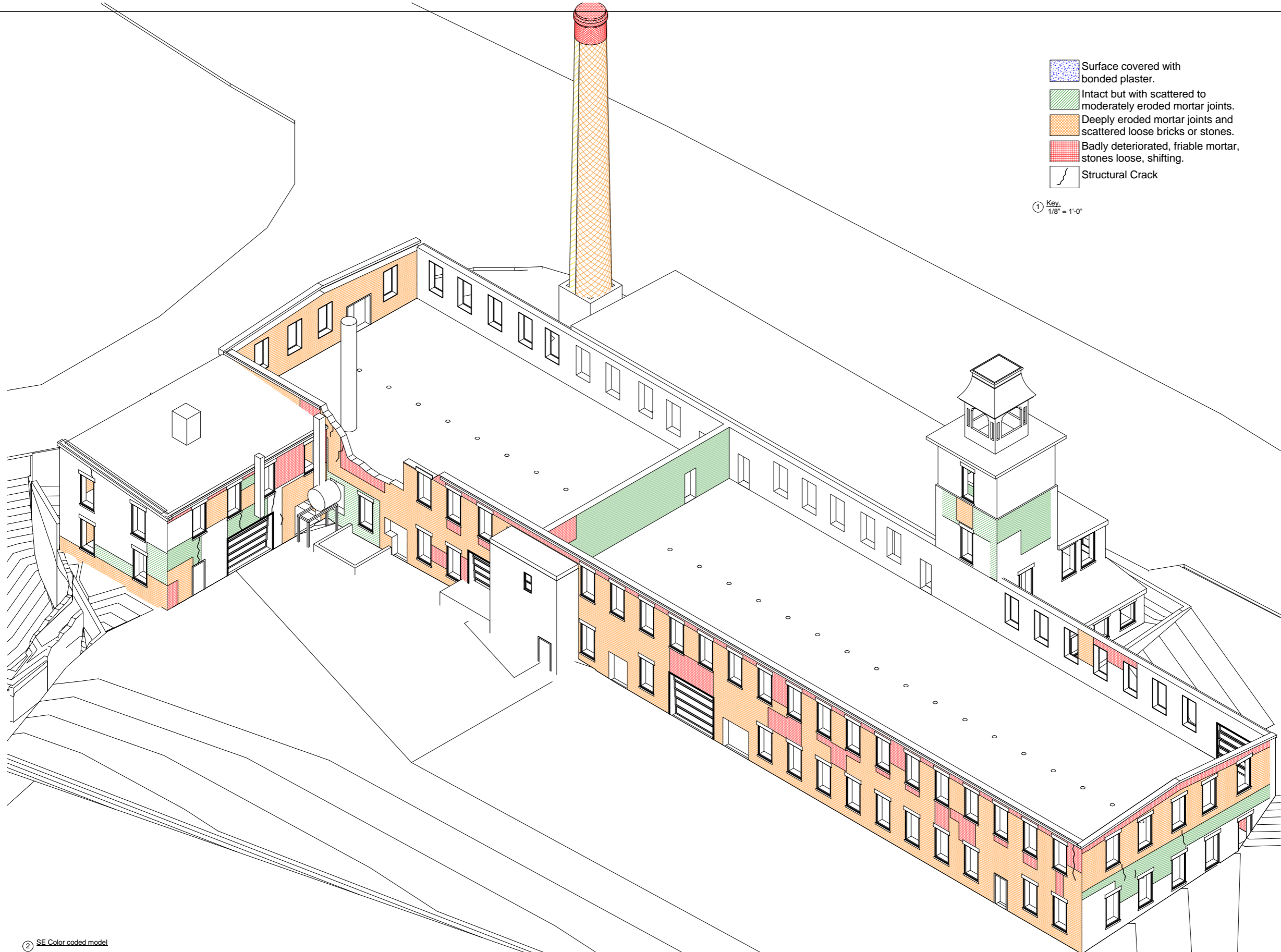

P:\3246 Westford Abbot Mill Preservation Study\dwg\Rev\3246 12 N Main Street Westford.rvt
 8/26/2015 5:51:41 PM Author

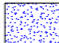
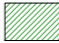
③ NW Color Coded Model



-  Surface covered with bonded plaster.
-  Intact but with scattered eroded mortar joints.
-  Deeply eroded mortar joints and scattered loose bricks or stones.
-  Badly deteriorated, friable mortar, stones loose, shifting.
-  Structural Crack

① Key.
1/8" = 1'-0"

② SE Color coded model

P:\3246 Westford Abbot Mill Preservation Study\dwg\Rev\3246 12 N Main Street Westford.nrt
8/26/2015 5:51:48 PM
Author

ARCHITECT
bh+a
Bargmann Hendrie + Archetype, Inc.
300 A Street
Boston, MA 02210
617 350-0450 Tel

PROJECT NAME
12 North Main Street

CLIENT
Town of Westford MA

PROJECT TEAM

REVISIONS

1	
2	
3	
4	
5	

DATE

DRAWING TITLE
Color Coded Structural Condition Assessment View from SE

DRAWING INFORMATION

Issue Date _____
DATE OF ISSUE _____
Schematic Design _____
DESCRIPTION _____
1/8" = 1'-0" Author _____
SCALE DRAWN BY _____
3246 3246 12NMainWestford.nrt
PROJECT # FILE NAME

DRAWING NUMBER

A205

Copyright BH+A, Inc.